

# Inflatable Set-up Instructions

- ❑ Setup area clear of all debris & sharp objects (i.e. branches, tables, power lines, etc.).
- ❑ Setup on dry level ground with a minimum of 5' of clearance around the entire inflatable.
- ❑ Position unit within 100' of a 20 amp outlet. If needed, use a 14 gauge extension cord.

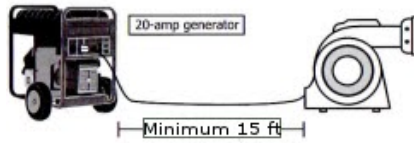

- ❑ Outdoor use, secure all ground anchors and tethers firmly at a 60° angle.
- ❑ Indoor use, secure the correct number of properly sized and weighted sandbags
- ❑ Attach blower to 1 inflation tube (tube must be fully extended and not twisted).
- ❑ Completely close all **blower tubes, zippers, and drain vents**.

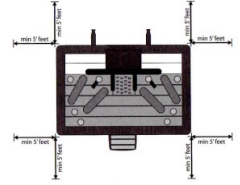
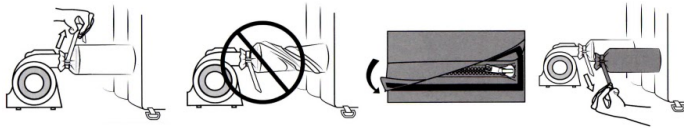
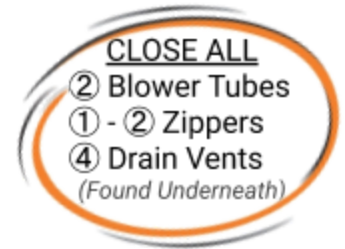

- ❑ Position all appropriate fencing, barricades, steps, and pads.
- ❑ Ensure all plugs are firmly secured and connected to a 20 amp outlet.
- ❑ Inspect all cords, anchors, tethers, surfaces, seams, and netting for rips or tears.
- ❑ Refer to safety warnings posted on unit.
- ❑ Provide appropriate number of trained operators to enforce all safety rules.
- ❑ Provide adequate lighting during night use.



## Inflatable Setup

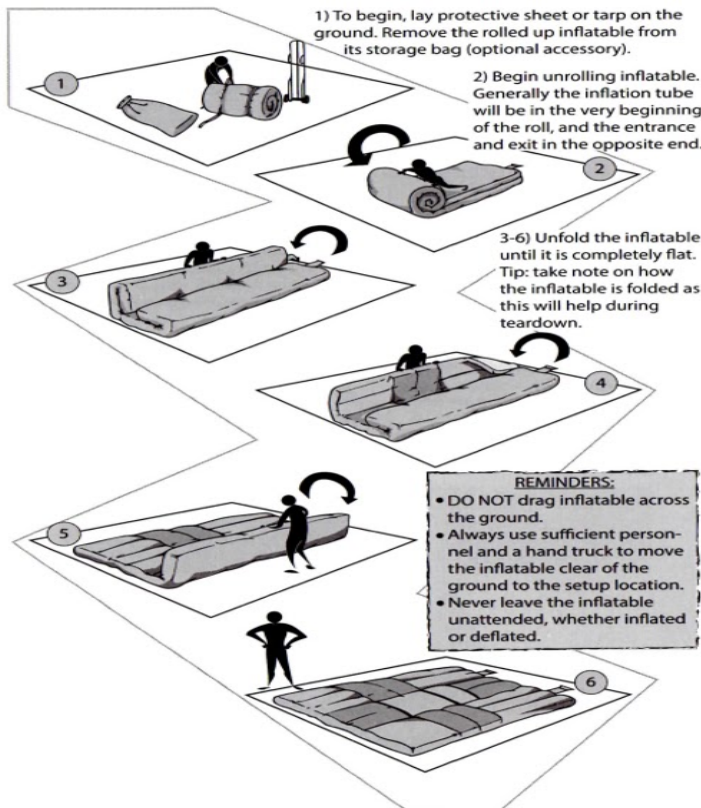

## Inflatable Takedown

